

Design Aitor García de Vicuña

**FAMO:**  
WORKING  
TOGETHER

# Set

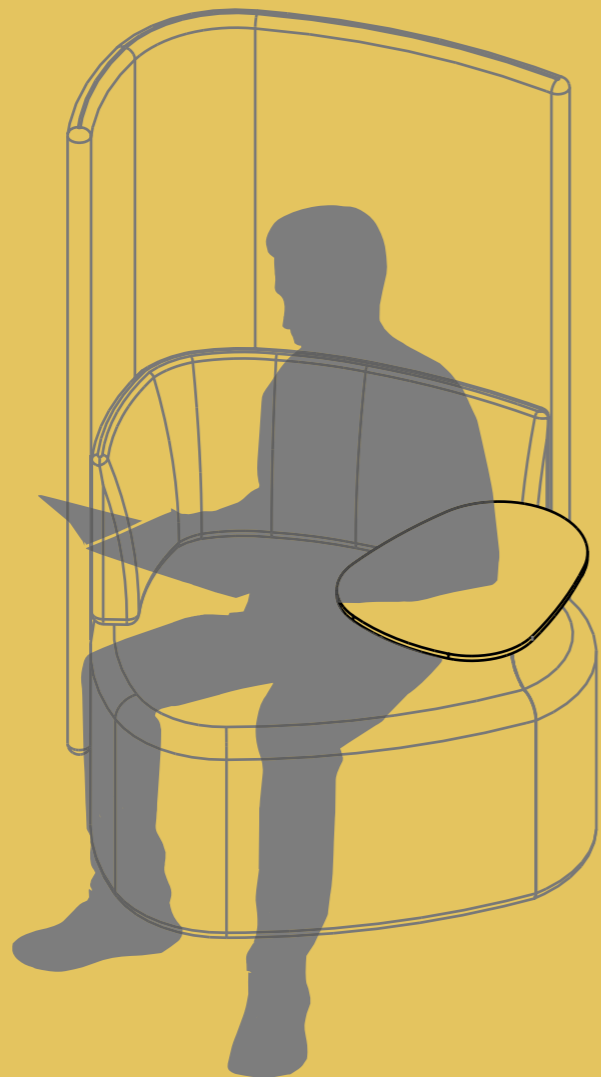



Design Aitor García de Vicuña

# Set

Soft volumes and warm materials seek a sense between emotion and personal cosiness. SET gives empowerment to people, to their daily needs in suggestive and transversal spaces. Balance between aesthetics and function, between artisan tradition and technology. A tool in the hands of professionals with the aim of finding logical and humane solutions to the challenges of new architectures.

Les formes douces et matières accueillantes recherchent un sens entre émotion et refuge personnel. SET donne du protagonisme aux personnes, à leurs besoins quotidiens dans des espaces suggestifs et transversaux, équilibre entre esthétique et fonction, entre tradition artisanale et technologie. Un outil entre les mains des professionnels dans le but de trouver des solutions logiques et humaines aux défis des nouvelles architectures.

Volúmenes suaves y materiales cálidos buscan un sentido entre emotividad y recogimiento personal. SET hace protagonista a las personas, a sus necesidades diarias en espacios sugestivos y transversales. Equilibrio entre estética y función, entre tradición artesanal y tecnología. Una herramienta en manos de profesionales con el objetivo de encontrar soluciones lógicas y humanas a los desafíos de las nuevas arquitecturas.

Weiche Volumen und warme Materialien suchen ein Gefühl zwischen Emotion und persönlicher Gemütlichkeit. SET gibt den Menschen die Möglichkeit, ihre täglichen Bedürfnisse in suggestiven und transversalen Räumen zu erfüllen. Balance zwischen Ästhetik und Funktion, zwischen handwerklicher Tradition und Technologie. Ein Werkzeug in den Händen von Fachleuten mit dem Ziel, logische und menschliche Lösungen für die Herausforderungen neuer Architekturen zu finden.

Volumes suaves e materiais acolhedores procuram um sentido entre a emoção e o refúgio pessoal. SET dá protagonismo às pessoas, às suas necessidades diárias em espaços suggestivos e transversais. Equilíbrio entre estética e função, entre tradição artesanal e tecnologia. Uma ferramenta nas mãos de profissionais com o objetivo de encontrar soluções lógicas e humanas para os desafios das novas arquiteturas.

# SETSYSTEM







USE  
YOUR  
IMAG-  
INA-  
TION

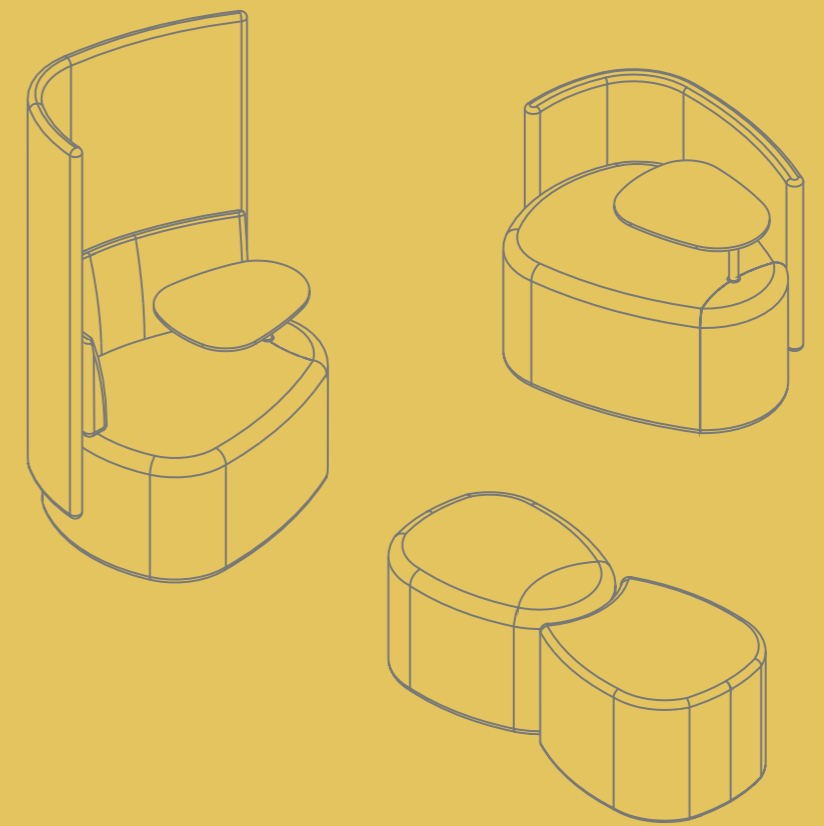
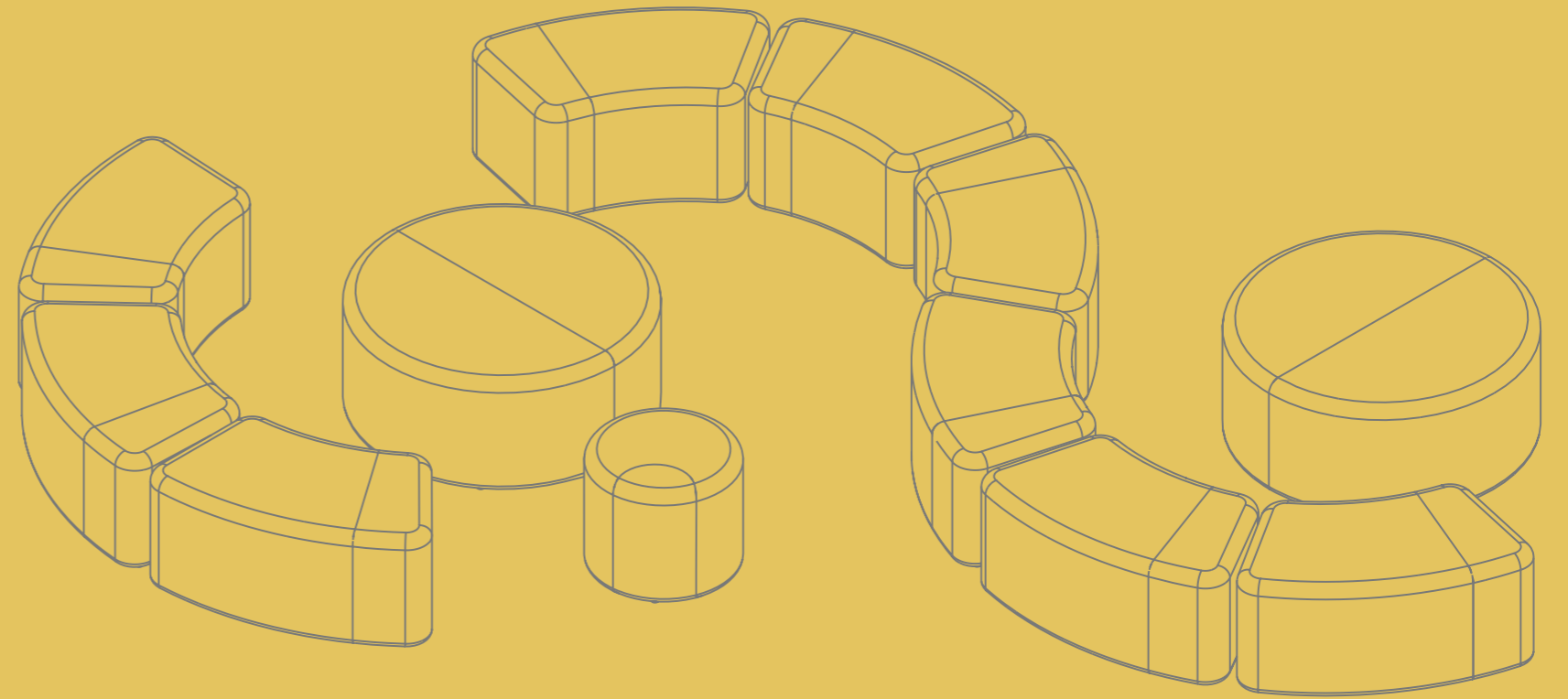
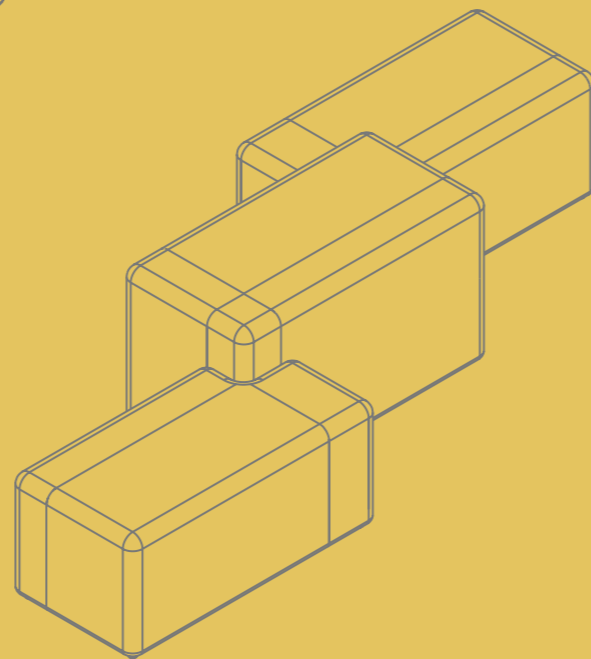
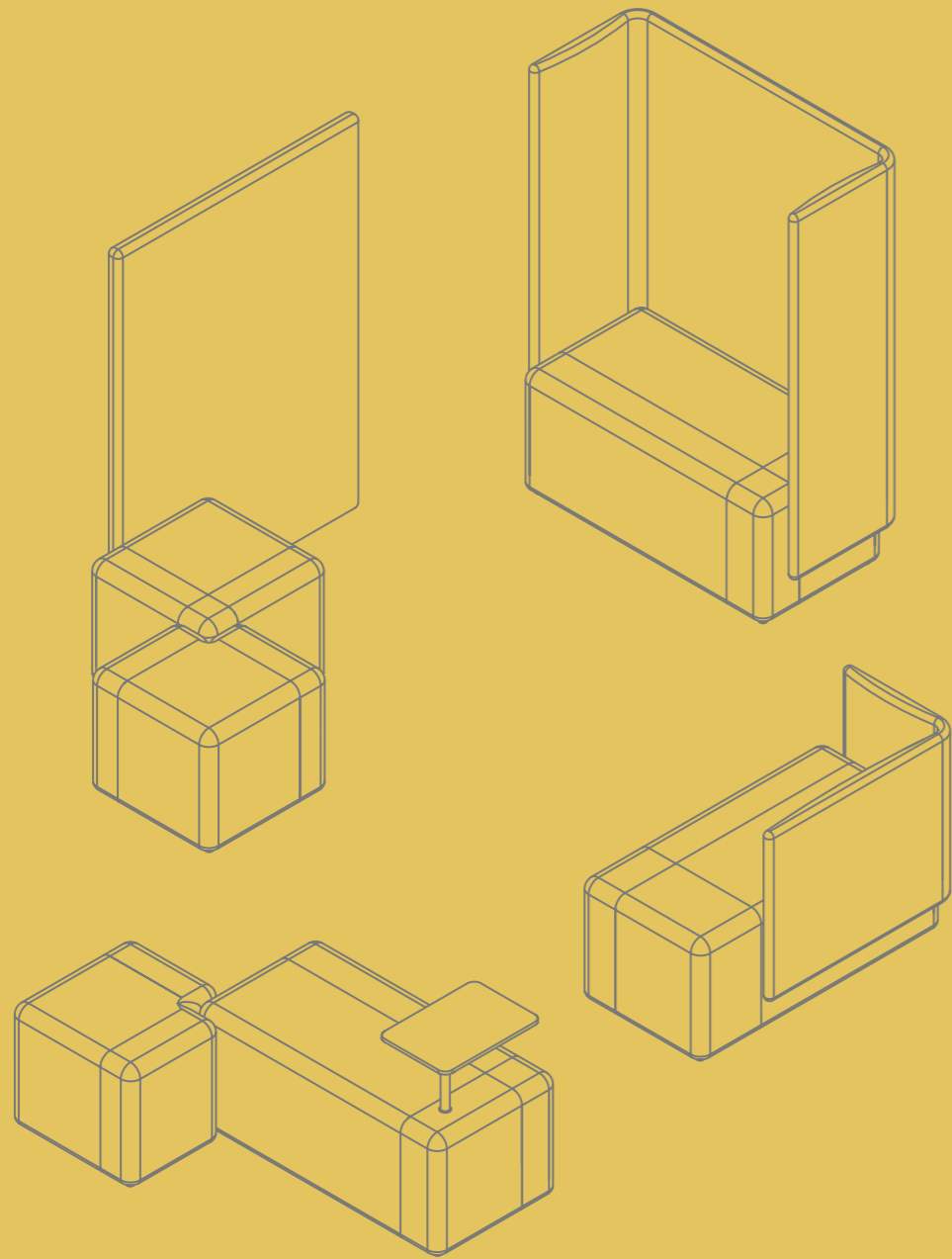

# FLEX- IBILI- TY

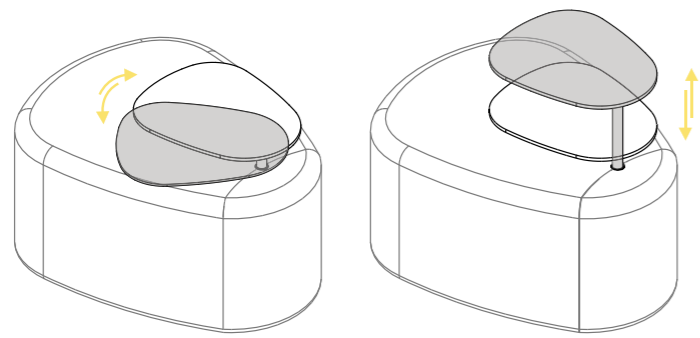

# COL- LABO- RATIVE





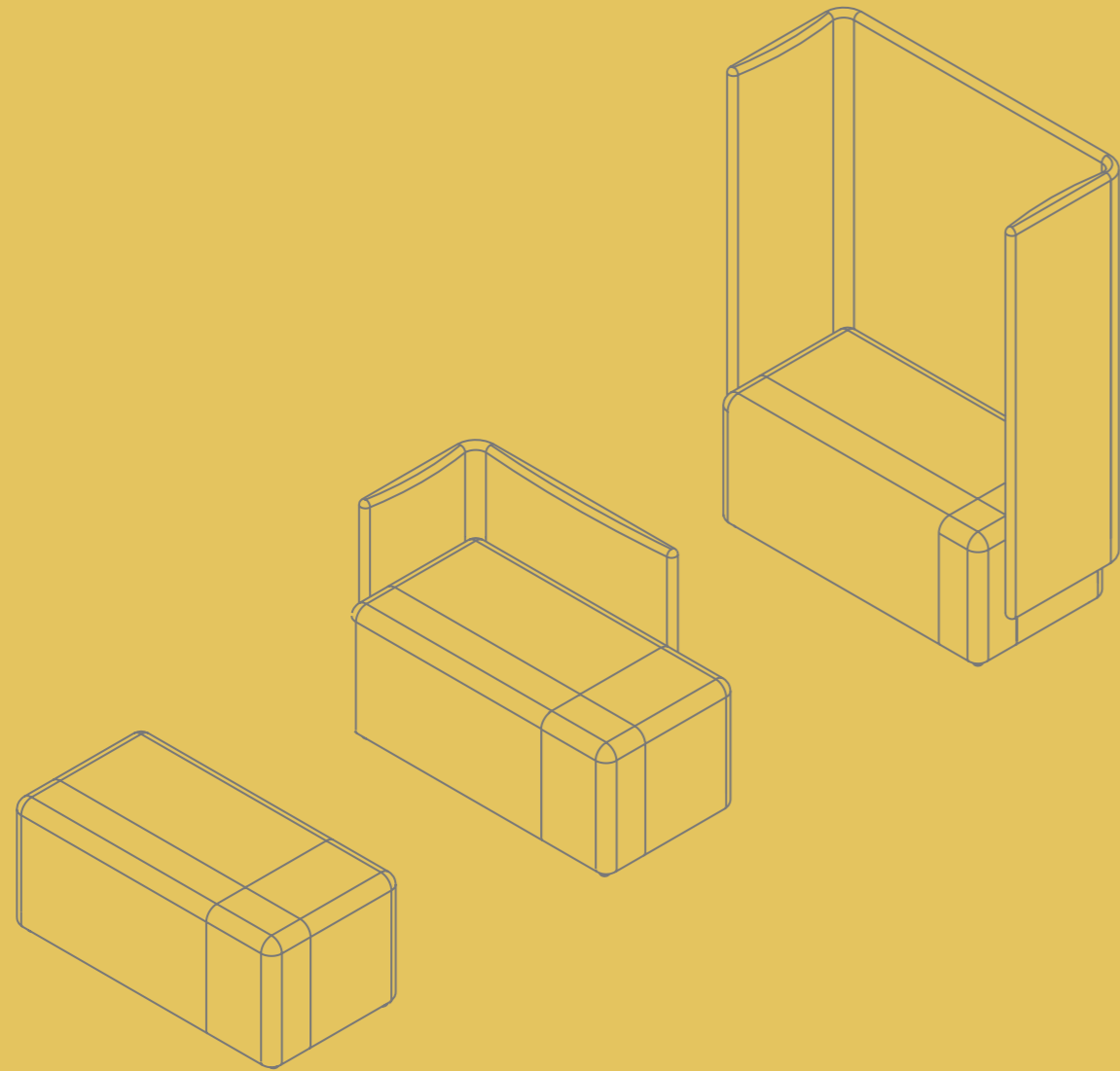



# LOGIC BEHIND THE SHAPES



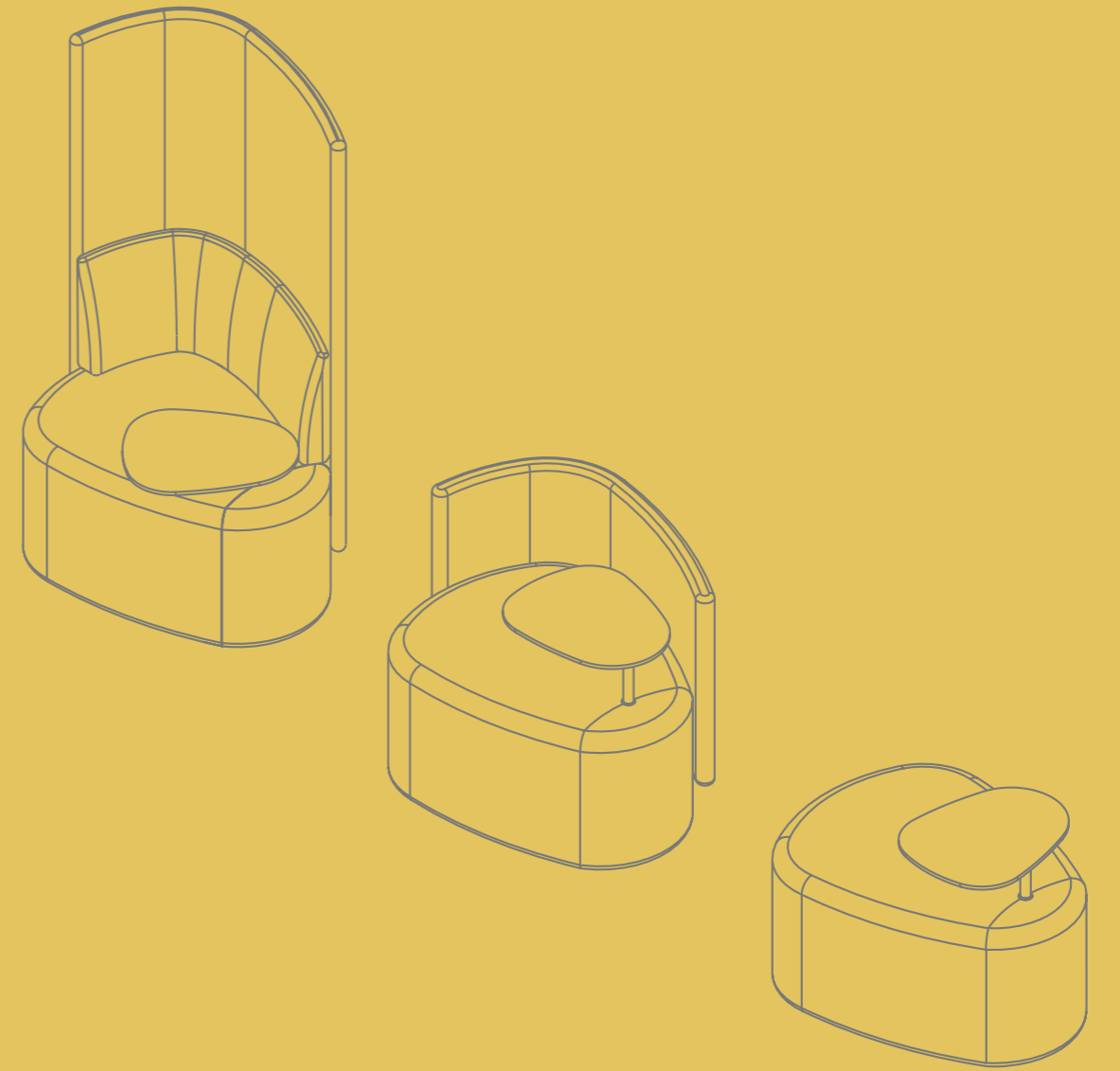





# SET STRAIGHT

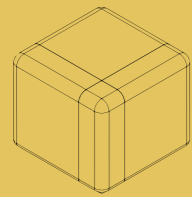

W 500 x D 500 x H 440

Square  
Carré  
Cuadrado  
Viereckig  
Quadrado

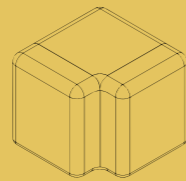

W 500 x D 500 x H 440

Square with cut-out  
Carré avec découpe  
Cuadrado con recorte  
Viereckig mit ausschnitt  
Quadrado com recorte

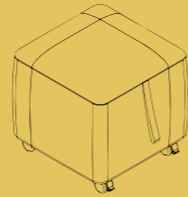

W 500 x D 500 x H 450

Square with wheels  
Carré avec roues  
Cuadrado con ruedas  
Viereckig mit rollen  
Quadrado com rodas

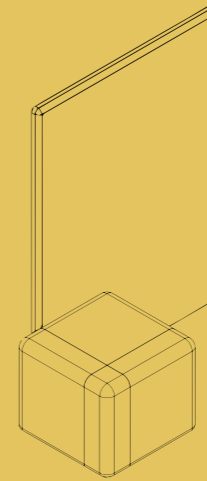

W 1130 x D 550 x H 1460

Square with divider  
Carré avec division  
Cuadrado con separador  
Viereckig mit trennwand  
Quadrado com divisória

# SET STRAIGHT

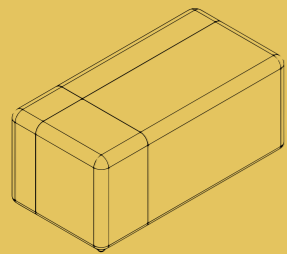

W 1000 x D 500 x H 440

Rectangular  
Rectangulaire  
Rectangular  
Rechteckig  
Retangular

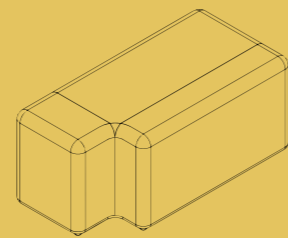

W 1000 x D 500 x H 440

Rectangular with cut-out  
Rectangulaire avec découpe  
Rectangular con recorte  
Rechteckig mit ausschnitt  
Retangular com recorte

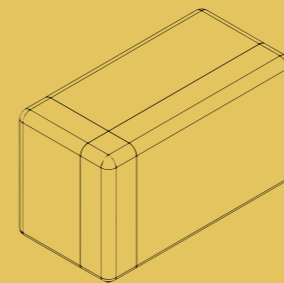

W 1000 x D 500 x H 590

High rectangular  
Rectangulaire haut  
Rectangular alto  
Hoch rechteckig  
Retangular alto

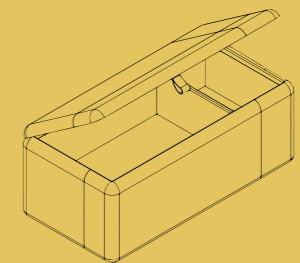

W 1000 x D 500 x H 440

Archive rectangular  
Archive rectangulaire  
Archivo rectangular  
Archiv rechteckig  
Arquivo retangular



# SET STRAIGHT

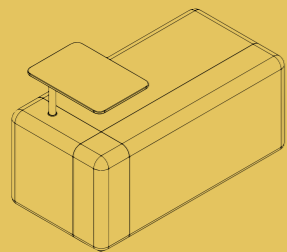

W 1000 x D 500 x H 440-640

Rectangular with mobile table  
Rectangulaire avec table mobile  
Rectangular con mesa móvil  
Rechteckig mit tisch  
Retangular com mesa

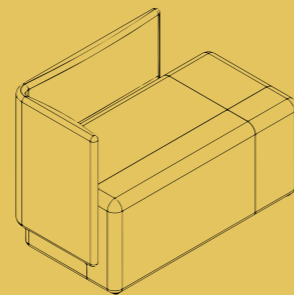

W 1050 x D 535 x H 730

Rectangular with back  
Rectangulaire avec dossier  
Rectangular con trasera  
Rechteckig mit rücken  
Retangular com costa

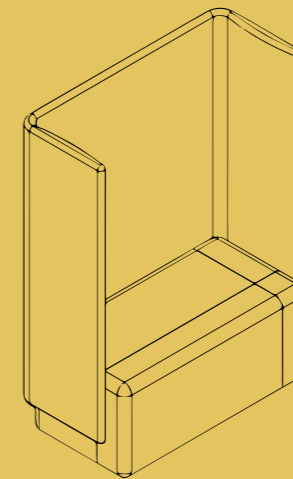

W 1100 x D 535 x H 1460

High back rectangular  
Rectangulaire dossier haut  
Rectangular con trasera alta  
Rechteckig mit hohe rückenlehne  
Retangular com costa alta

# SET CURVED



W 400 x D 400 x H 445

Stool  
Tabouret  
Banco  
Hocker  
Banco



W 500 x D 500 x H 440

Round  
Rond  
Redondo  
Rund  
Redondo



W 500 x D 500 x H 440

Round with cut-out  
Rond avec découpe  
Redondo con recorte  
Rund mit ausschnitt  
Redondo com recorte

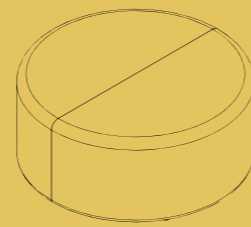

W 1000 x D 1000 x H 440

Big round  
Grand rond  
Grande redondo  
Rund groß  
Redondo grande

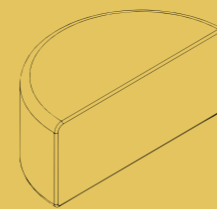

W 1000 x D 500 x H 440

Big round (half)  
Grand rond (moitié)  
Grande redondo (medio)  
Rund groß (Half)  
Redondo grande (metade)

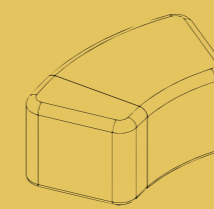

W 945 x D 540 x H 440

Curved  
Incurvé  
Curvo  
Gebogen  
Curvo

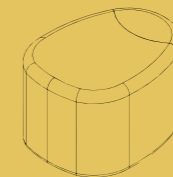

W 690 x D 530 x H 440

Pebble  
Pebble  
Pebble  
Pebble  
Pebble

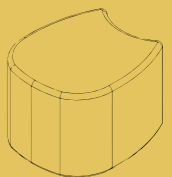

W 600 x D 530 x H 440

Pebble with cut-out  
Pebble avec découpe  
Pebble con recorte  
Pebble mit ausschnitt  
Pebble com recorte

# SET CURVED



W 825 x D 650 x H 390

Coffee table  
Petite table  
Mesa pequeña  
Beistelltisch  
Mesa de apoio

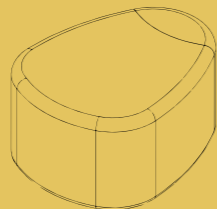

W 850 x D 680 x H 440

Pebble  
Pebble  
Pebble  
Pebble  
Pebble

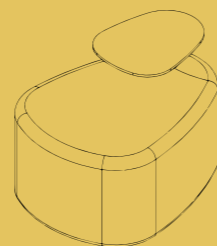

W 860 x D 680 x H 440-640

Pebble with mobile table  
Pebble avec table mobile  
Pebble con mesa móvil  
Pebble mit mobiler tisch  
Pebble com mesa móvel

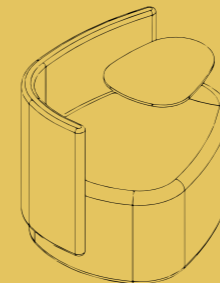

W 890 x D 710 x H 730

Pebble with mobile table and back  
Pebble avec table mobile et dossier  
Pebble con mesa móvil y trasera  
Pebble mit mobiler tisch und rückenlehne  
Pebble com mesa móvel e costa

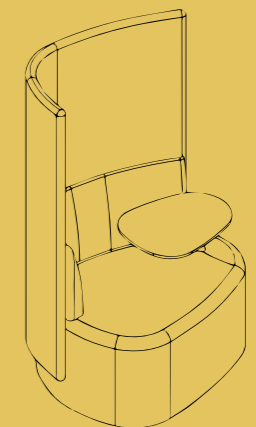

W 890 x D 720 x H 1460

Pebble with mobile table and high back  
Pebble avec table mobile et dossier haut  
Pebble con mesa móvil y trasera alta  
Pebble mit mobiler tisch und hohe rückenlehne  
Pebble com mesa móvel e costa alta

# WORKING TOGETHER

A FAMO reserva-se no direito de modificar e melhorar as características dos produtos apresentados neste catálogo, a fim de atender às exigências do mercado. Embora reproduzidos o mais fielmente possível, as cores dos produtos ilustrados podem ser diferentes daqueles dos produtos reais. Os veios das madeiras são indicativos e podem variar de acordo com o lote de produção. Para obter informações precisas sobre as especificações detalhadas dos produtos, consulte-nos.

FAMO reserves the right to modify and improve the characteristics of the products shown in this catalogue in order to meet market requirements. Although reproduced as faithfully as possible, the product colours illustrated may differ from those of actual products. The grain of the veneers illustrated are indicative and will vary according to the production batch. For accurate information on detailed product specifications, please contact us.



**FAMO:**  
WORKING  
TOGETHER

IND. MOBILIÁRIO ESCRITÓRIO, LDA  
RUA 1º MAIO, Nº 112, 4620-131 - LOUSADA  
TEL +351 255 810 580 | FAX +351 255 810 589

**WWW.FAMO.PT**

1 - 1 / 2022

